

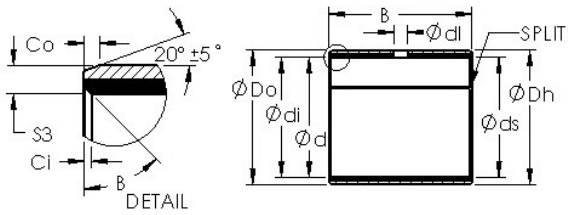

BEARING FORGE OF AMERICA CORP.



AST AST50 48IB36 plain bearings

Bearing No. AST50 48IB36

Bore Diameter	76,2 mm
Bearing Type	straight
Shaft Dia., Nominal (d)	3.0000
Shaft Size (ds) - 3	2.9982
Housing Bore Dia. (Dh) - 3.1872	3.1858
Bearing Bore after Mounting (di) - 3.0068	3.0002
Average Clearance (Cd)	0.0043
Wall Thickness (S3)	0.095
Bearing Length, Nominal (B)	2.250
Bearing Length Tolerance (B tol.) - +.010 / -0.010	+0.010 / 0.010
OD Chamfer Length (Co)	0.072
ID Chamfer Angle (B deg.)	30
ID Chamfer Length (Ci)	0.031
Material	Carbon steel shell with PTFE / Fiber lining

AST50 48IB36 Bearing 2D drawings and 3D CAD models