

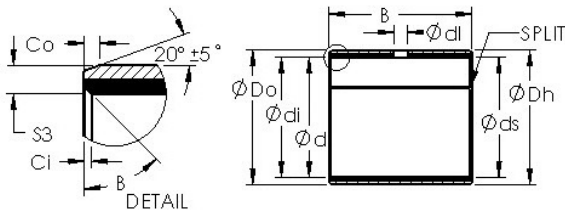

BEARING FORGE OF AMERICA CORP.



AST AST40 1410 plain bearings

Bearing No. AST40 1410

Bore Diameter	14 mm
Outer Diameter	16 mm
Bearing Type	straight
Shaft Dia., Nominal (d)	14.0000
Shaft Size (ds) - 14 -0.016 / -0.034	14 0.016 / 0.034
Housing Bore Dia. (Dh)	16 +0.018 / +0
Bearing Outside Diameter, Nominal (Do)	16.000
Bearing Outside Diameter Tolerance (Do tol.)	16.065 / 16.03
Bearing Bore after Mounting (di)	14.058 / 13.99
Average Clearance (Cd)	0.0490
Wall Thickness (S3)	1.005
Bearing Length, Nominal (B)	10.000
Bearing Length Tolerance (B tol.) - +0 / -0.30	+0 / 0.30
OD Chamfer Length (Co)	0.600
ID Chamfer Angle (B deg.)	30
ID Chamfer Length (Ci)	0.300
Material	Steel shell with PTFE / Polymer Fiber lining

AST40 1410 Bearing 2D drawings and 3D CAD models