

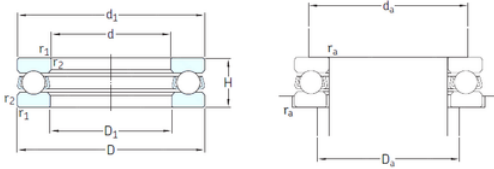

BEARING FORGE OF AMERICA CORP.



skf 51205 bearing

Bearing No. 51205

Size	25x47x15 mm
Bore Diameter	25 mm
Outer Diameter	47 mm
Width	15 mm
d	25 mm
D	47 mm
H	15 mm
d1	47 mm
r1 min.	0,6 mm
r2 min.	0,6 mm
D1	27 mm
da min.	38 mm
Da max.	34 mm
ra max.	0,6 mm
Weight	0,11 Kg
Basic dynamic load rating (C)	26,5 kN
Basic static load rating (C0)	50 kN
Fatigue load limit (Pu)	1,86
Reference speed	5300 r/min
Limiting speed	7500 r/min
Category	Thrust Ball Bearing
Inventory	2.0
Manufacturer Name	SKF
Minimum Buy Quantity	N/A
Weight / Kilogram	0.117
EAN	7316577058522

51205 Bearing 2D drawings and 3D CAD models



BEARING FORGE OF AMERICA CORP.

Product Group	B00308
Rolling Element	Ball Bearing
Thrust Bearing	Yes
Single or Double Direction	Single Direction
Banded	No
Cage Material	Steel
Precision Class	ABEC 1 ISO P0
Component Description	Roller Assembly Plus Raceways
Other Features	Single Row
Long Description	25MM Bore 1; 27MM Bore 2; 47MM Outside Diameter; 15MM Height; Ball Bearing; Single Direction; Not Banded; Steel Cage; ABEC 1 ISO P0 Precision
Inch - Metric	Metric
Category	Thrust Ball Bearings
UNSPSC	31171507
Harmonized Tariff Code	8482.10.50.08
Noun	Bearing
Keyword String	Ball Thrust
Manufacturer URL	http://www.skf.com
Manufacturer Item Number	51205
Weight / LBS	0.257
Bore 2	1.063 Inch 27 Millimeter
Height	0.591 Inch 15 Millimeter
Overall Height with Aligning Washer	0 Inch 0 Millimeter
Bore 1	0.984 Inch 25 Millimeter
Outside Diameter	1.85 Inch 47 Millimeter
bore diameter:	25 mm
static load capacity:	50 kN
outside diameter:	47 mm



BEARING FORGE OF AMERICA CORP.

dynamic load capacity:	26.5 kN
overall width:	15 mm
maximum rpm:	7500 RPM
thrust bearing type:	Single-Direction
cage material:	Steel
outside diameter design:	Straight
fillet radius:	0.6 mm
separable or banded:	Separable
series:	512
precision rating:	ABEC 1 (ISO Class Normal)
d_1	47 mm
D_1	27 mm
$r_{1,2}$ min.	0.6 mm
d_a min.	38 mm
D_a max.	34 mm
r_a max.	0.6 mm
Basic dynamic load rating C	26.5 kN
Basic static load rating C_0	50 kN
Fatigue load limit P_u	1.86 kN
Minimum load factor A	0.015
Mass bearing (including seat washer where applicable)	0.11 kg