

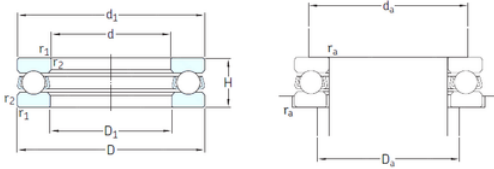

BEARING FORGE OF AMERICA CORP.



skf 51106 bearing

Bearing No. 51106

51106 Bearing 2D drawings and 3D CAD models

Size	30x47x11 mm
Bore Diameter	30 mm
Outer Diameter	47 mm
Width	11 mm
d	30 mm
D	47 mm
H	11 mm
d1	47 mm
r1 min.	0,6 mm
r2 min.	0,6 mm
D1	32 mm
da min.	40 mm
Da max.	37 mm
ra max.	0,6 mm
Weight	0,063 Kg
Basic dynamic load rating (C)	19 kN
Basic static load rating (C0)	43 kN
Fatigue load limit (Pu)	1,6
Reference speed	6000 r/min
Limiting speed	8500 r/min
Category	Thrust Ball Bearing
Inventory	13.0
Manufacturer Name	SKF
Minimum Buy Quantity	N/A
Weight / Kilogram	0.071
EAN	7316577058638



BEARING FORGE OF AMERICA CORP.

Product Group	B00308
Rolling Element	Ball Bearing
Thrust Bearing	Yes
Single or Double Direction	Single Direction
Banded	No
Cage Material	Steel
Precision Class	ABEC 1 ISO P0
Component Description	Roller Assembly Plus Raceways
Other Features	Single Row
Long Description	30MM Bore 1; 32MM Bore 2; 47MM Outside Diameter; 11MM Height; Ball Bearing; Single Direction; Not Banded; Steel Cage; ABEC 1 ISO P0 Precision
Inch - Metric	Metric
Category	Thrust Ball Bearings
UNSPSC	31171507
Harmonized Tariff Code	8482.10.50.08
Noun	Bearing
Keyword String	Ball Thrust
Manufacturer URL	http://www.skf.com
Manufacturer Item Number	51106
Weight / LBS	0.156
Bore 2	1.26 Inch 32 Millimeter
Height	0.433 Inch 11 Millimeter
Bore 1	1.181 Inch 30 Millimeter
Overall Height with Aligning Washer	0 Inch 0 Millimeter
Outside Diameter	1.85 Inch 47 Millimeter
bore diameter:	30 mm
static load capacity:	43 kN
outside diameter:	47 mm



BEARING FORGE OF AMERICA CORP.

dynamic load capacity:	19 kN
overall width:	11 mm
maximum rpm:	8500 RPM
thrust bearing type:	Single-Direction
cage material:	Steel
outside diameter design:	Straight
fillet radius:	0.6 mm
separable or banded:	Separable
series:	511
precision rating:	ABEC 1 (ISO Class Normal)
d_1	47 mm
D_1	32 mm
$r_{1,2}$ min.	0.6 mm
d_a min.	40 mm
D_a max.	37 mm
r_a max.	0.6 mm
Basic dynamic load rating C	19 kN
Basic static load rating C_0	43 kN
Fatigue load limit P_u	1.6 kN
Minimum load factor A	0.0096
Mass bearing (including seat washer where applicable)	0.063 kg